

LEASING REEDS

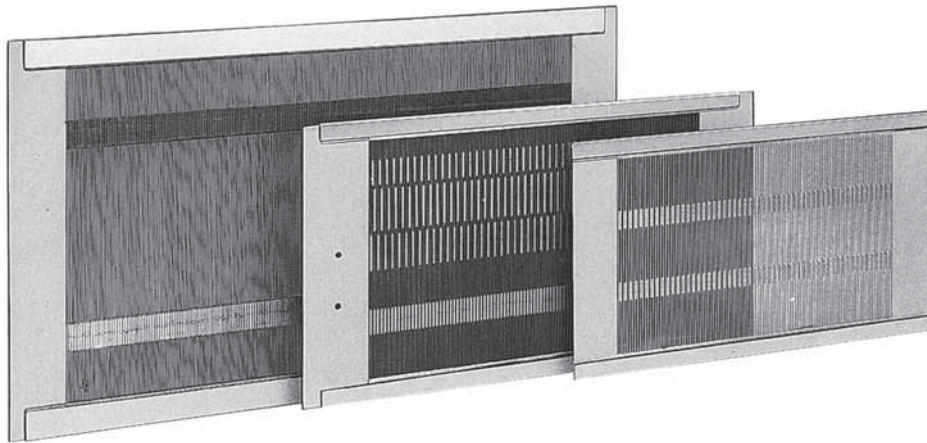

綾取箄の種類

Kinds of Leasing Reeds

2 段綾取箄 1 × 1 Lease Type

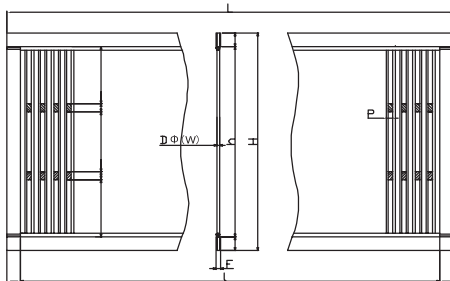

2 段綾取箄 2 × 2 Lease Type

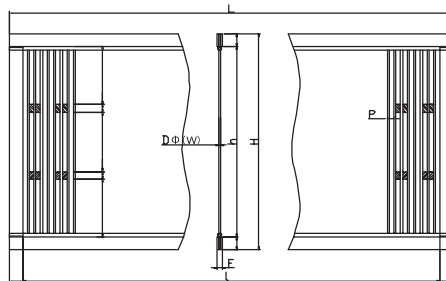

主な親羽形状 End Rib Options

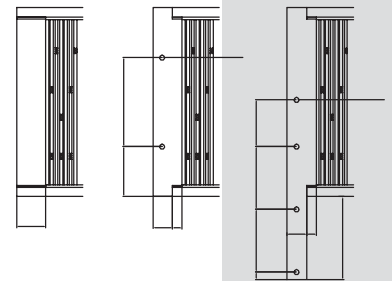

4 段綾取箄 4-way Lease Type

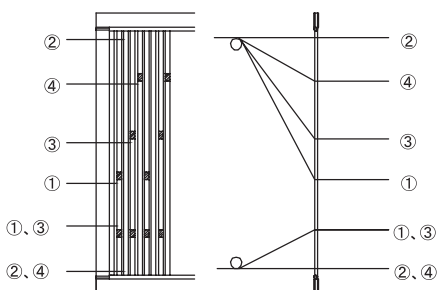

6 段綾取箄 6-way Lease Type

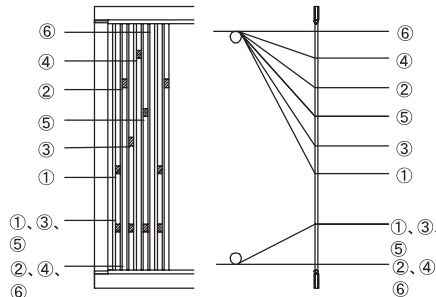

8 段綾取箄 8-way Lease Type

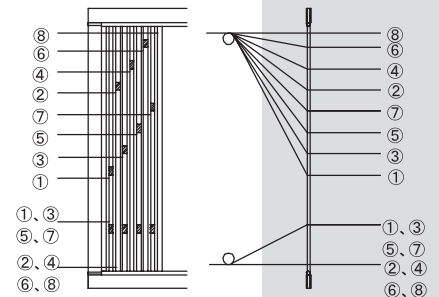

材質

- ピアノ線
- ステンレス線

表面加工

- 硬質クローム梨地メッキ仕上
 - 硬質クローム光沢メッキ仕上
- 表面硬度 HV800 以上
メッキ皮膜厚さ 5 μm 以上

Material

- Piano wire SWP.A.
- Stainless steel SUS304

Surface Treatment

- Mat hard chromium plated
 - Hard chromium plated
- Common Characteristics for All Options
Hardness over HV800
Plating thickness over 5 μm

TAKAYAMA REED CO.,LTD.
高山リード株式会社

2-27-20, JINGUJI, KANAZAWA, JAPAN 920-0806
TEL : +81-76-252-2266 FAX : +81-76-252-3134

石川県鹿島郡中能登町良川タ-60 〒929-1717
TEL : 0767-74-1223 FAX : 0767-74-1380

http://www.takayamareed.co.jp
E-mail : info@takayamareed.co.jp